



Northwoods  
Place

# GEARED for the FUTURE



Artist's Impression



1-bedroom Unit  
28.90 - 38.10 sq. m.  
*Artist's Impression*

Home Office  
Tower 1 & 2 - 2nd, 3rd & 5th Floors  
23.40 sq. m. - 77.70 sq. m.  
*Artist's Impression*



*Artist's Impression*

More units available.



**Studio Unit A3**  
Tower 1      Tower 2  
6th - 18th Floor    6th - 10th Floor  
28 sq. m.



**1-bedroom Unit B2**  
Tower 2  
6th - 10th Floor  
31.30 sq. m.

## PRILAND Advantage

Where others cut corners,  
Priland Residences delivers,  
as fixtures that support ease  
of connectivity and convenience  
come standard in every project.

- Provision for Aircon
- Provision for Telephone
- Provision for Cable
- Provision for Induction Stove
- Provision for Range Hood
- Sprinklers
- Smoke & Heat Detectors

### FEATURES

#### RESIDENTIAL AREAS

- Reception Area
- Lounge Area
- 3 Elevators shared by 2 Towers
- Central Garbage Collection Area (MRF)
- Provision for Garbage Collection on Every Floor
- 1.50-meter-wide Hallway
- 100% Back Up Power

#### AMENITIES

- Swimming Pool with Gazebo
- Gym
- Commercial Spaces
- Outdoor Shower

#### PARKING

- Lower Ground Parking for Residents
- Surface Parking for Commercial/Retail

#### CCTV

- Ground Floor Lobby & Reception
- Elevator Cars
- Amenities Area
- Parking Entrance
- Retail Area Perimeter
- Hallways
- Upper & Lower Ground Parking Levels

### Retail Spaces for Sale

#### Upper Ground Floor

- Retail 1 : 41.44 sq. m.
- Retail 2 : 42.81 sq. m.
- Retail 3 : 36.39 sq. m.
- Retail 5 : 36.65 sq. m.
- Retail 6 : 53.04 sq. m.
- Retail 7 : 50.55 sq. m.

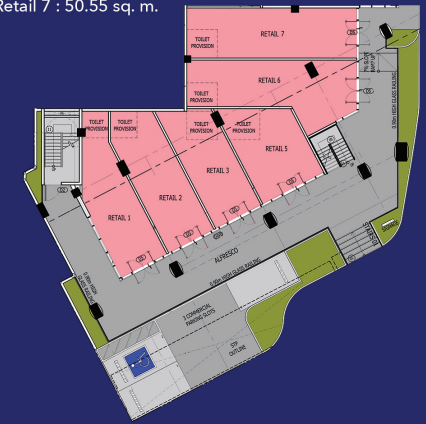



Corporate Address:  
Priland Hive, 18th Floor, BPI Cebu Corporate Center  
cor. Archbishop Reyes and Luzon Ave.,  
Cebu Business Park, Cebu City, Cebu

LTS Number:  
Tower 1: LS-07-20-018 and Tower 2: LS-07-20-019

 032 517 9645

 [priland.com.ph](http://priland.com.ph)

 PrilandOfficial

Project Location: Canduman, Mandaue City

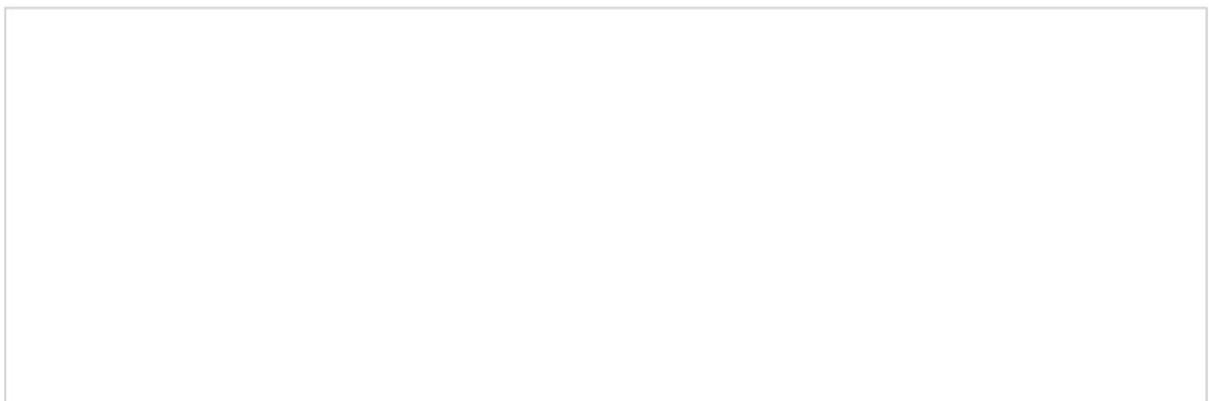

FOR ANNOUNCEMENT PURPOSES ONLY.

*All images are creative interpretations.*